



SCHOOL FACILITIES PLANNING

DISCUSSION ON SWING SPACES



March 6, 2017



Aim of Tonight's Presentation – *Provide Explanations*

1. Explain why swing space and/or additional classroom space is necessary?
 - Use for temporary classrooms
 - Enrollment increases
 - Programmatic reasons

2. Present proposals to increase space at:
 - BMPRSS
 - BBMS
 - BBHS



Temporary Classrooms at Enrichment Center Area

During construction of the new addition at BMPRSS we will need to relocate (8) classrooms throughout the other building wings.

Two temporary classrooms will be needed in the existing enrichment center.



Enrichment Center as it Exists Now

Slide altered for website posting



EXISTING PLAN / LOWER LEVEL

Enrichment Center – Temporary Classrooms (2 Designs)

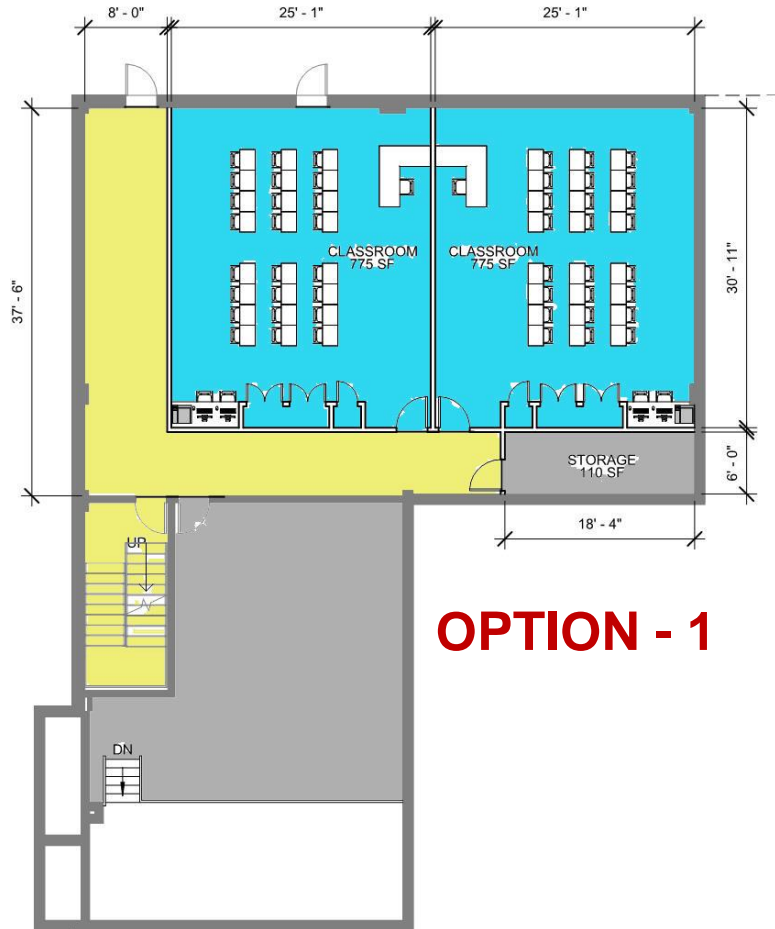

OPTION - 1

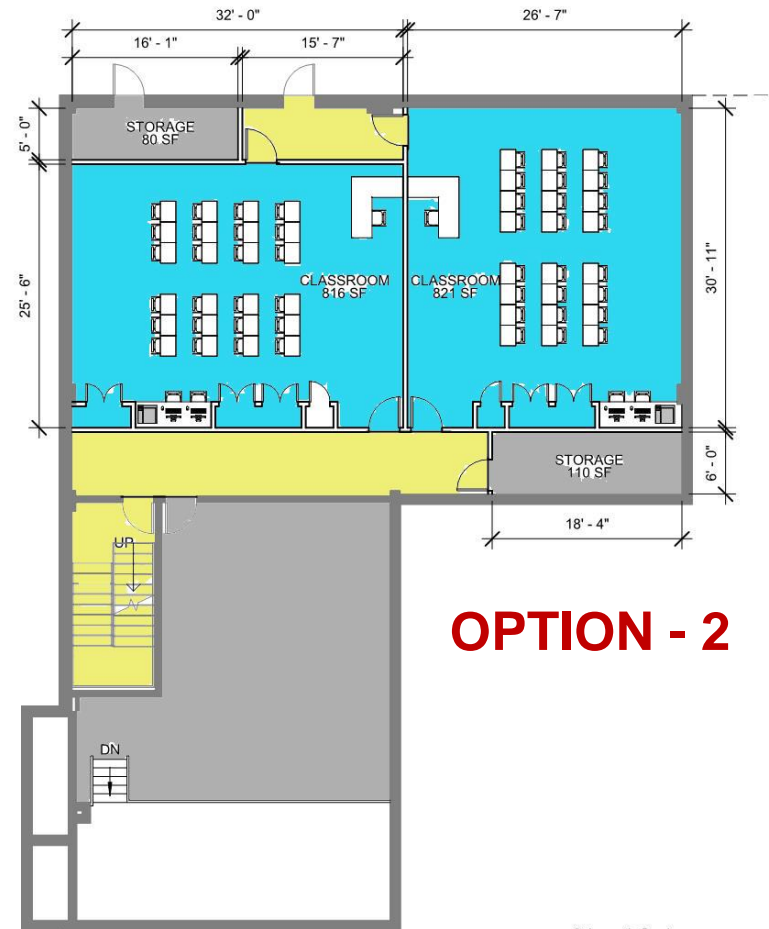

OPTION - 2

① TEMP CLASSROOMS AT BASEMENT
 3/32" = 1'-0"

② TEMP CLASSROOMS AT BASEMENT
 3/32" = 1'-0"

SK-01 Schematic Design
TEMPORARY CLASSROOM OPTIONS

3/32" = 1'-0"
 April 18, 2016
1508

Blind Brook Public Schools

390 Ridge Street, Rye Brook, NY 10573
Kilment Halsband Architects
 322 Eighth Avenue, New York, NY 10001

PROPOSED TEMP. LAYOUT / LOWER LEVEL



Enrichment Center – Permanent Home for PS Offices

Slide altered for website posting

PROPOSED FINAL LAYOUT / LOWER LEVEL (after construction)



Enrichment Center – Permanent Home for PS Offices

Slide altered for website posting

PROPOSED FINAL LAYOUT / UPPER LEVEL



Swing Space Options at BMRSS

New Addition 1st Floor
Five Classrooms

New Addition 2nd Floor
Five Classrooms

Slide altered for website posting

Swing Space Option for BBHS – 1st Floor Option



slide altered
for website
posting

FABRICATION LAB / 1ST FLOOR PLAN

Swing Space Option for BBHS – 2nd Floor Option



slide altered
for website
posting

FABRICATION LAB / 2ND FLOOR PLAN



MIDDLE SCHOOL LOCKER AREA

slide altered for website posting

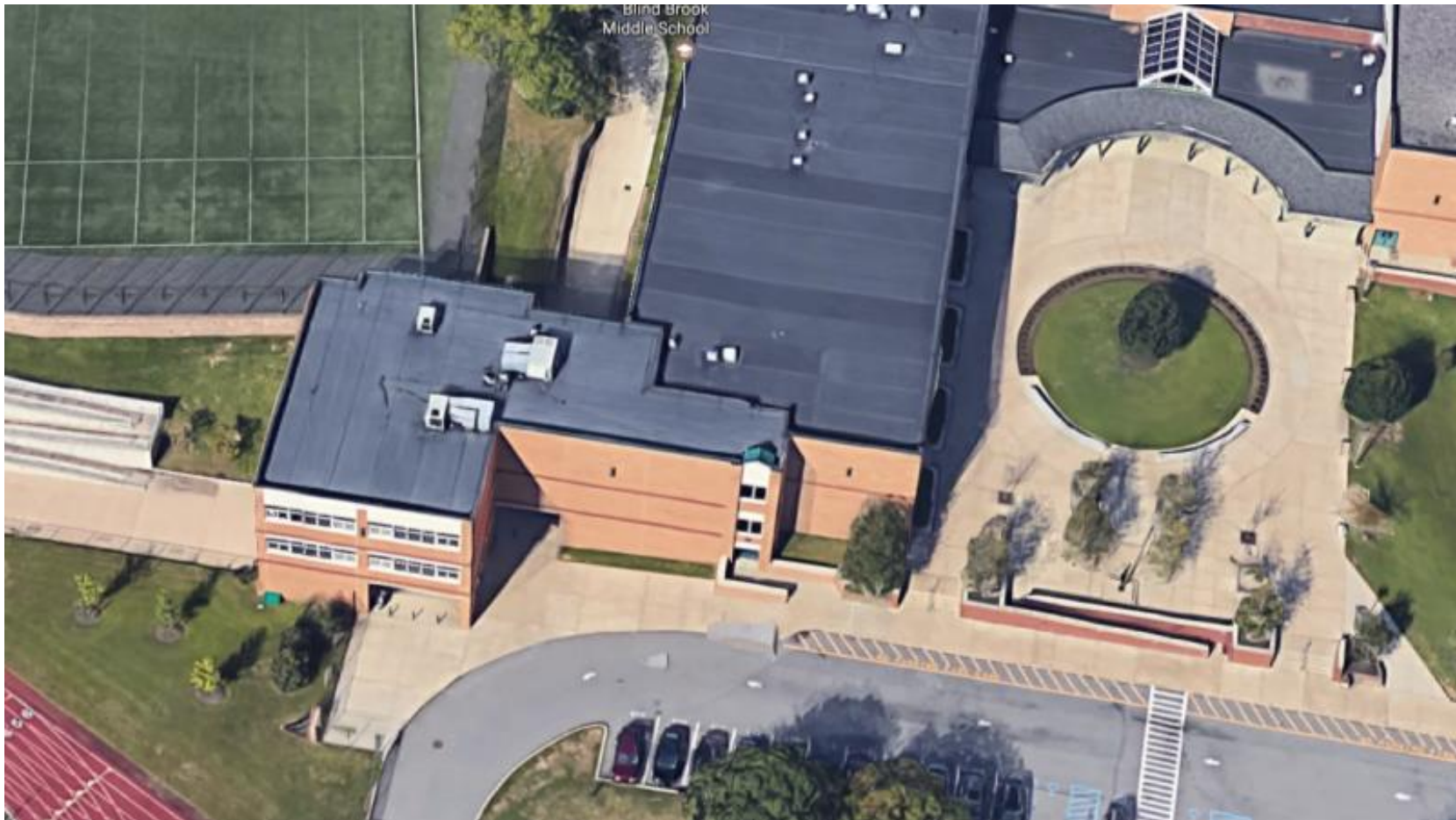

MIDDLE SCHOOL LOCKER AREA 1ST FLOOR / EXISTING

MIDDLE SCHOOL LOCKER AREA

slide altered for website posting

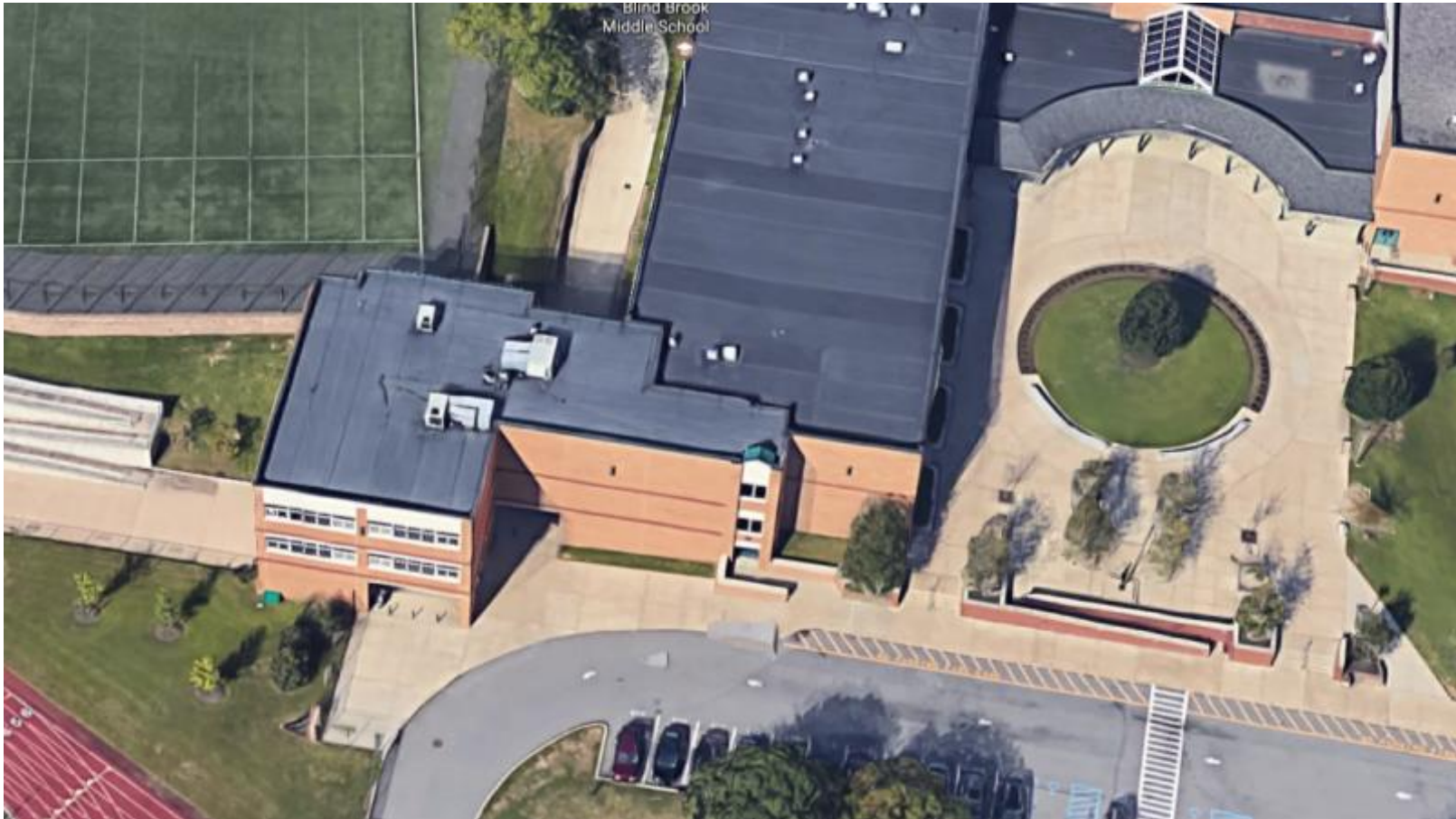

MIDDLE SCHOOL LOCKER AREA 1ST FLOOR / PROPOSED



Projected School/District Enrollments for the Next 5 Years

	<u>2017-18</u>	<u>2018-19</u>	<u>2019-20</u>	<u>2020-21</u>	<u>2021-22</u>
PRSS	627	626	627	615	596
BBMS	325	346	327	342	355
BBHS	490	462	464	439	434
TOTAL	1,442	1,434	1,418	1,396	1,385

Per Demographer Report January 2017 (includes Sun Homes projections)



Estimated Cost of Additional Swing Space Proposals

1. **BMPRSS –**

Two additional classrooms in new addition

Costs included in total projected BMPRSS cost estimate

2. **BBMS –**

Relocate 1st floor locker banks to new MS-to-HS corridor and construct one classroom where lockers are now

\$250,000

3. **BBHS –**

Alt A. convert existing storage to one classroom

\$300,000

Alt B. construct addition over existing classrooms H107 & H108

\$1,750,000

